

COMBO®

Lightweight, Low Profile,
Functional Orthotic Solution

... for the management of genu-recurvatum
accompanied with foot drop.



Therapy, Reimbursement, and Patient Friendly!

- The thigh cuff/knee control assembly is easily removed from the BlueROCKER or ToeOFF.
- Great for rehab programs where extension control may no longer be required as treatment progresses, eliminates the need for a prescription for a 2nd orthosis!
- Great for patient when relaxing and extension control is not required.
- Easy to don and doff
- Quick release buckles and straps

BlueROCKER Item No. Left	BlueROCKER Item No. Right	Size	Footplate Length	Height
28405 1010	28405 2010	X-Small	8 1/4"	14"
28405 1011	28405 2011	Small	9"	15"
28405 1012	28405 2012	Medium	9 5/8"	16"
28405 1013	28405 2013	Large	10 5/8"	17"
28405 1014	28405 2014	X-Large	11 1/4"	17"

BlueROCKER 2.0 w/D-Ring Item No. Left	BlueROCKER 2.0 w/D-Ring Item No. Right	BlueROCKER 2.0 w/o D-Ring Item No. Left	BlueROCKER 2.0 w/o D-Ring Item No. Right	Size	Footplate Length	Height
28942 1010	28942 2010	28940 1010	28940 2010	X-Small	8 1/4"	14"
28942 1011	28942 2011	28940 1011	28940 2011	Small	9"	15"
28942 1012	28942 2012	28940 1012	28940 2012	Medium	9 5/8"	16"
28942 1013	28942 2013	28940 1013	28940 2013	Large	10 5/8"	17"
28942 1014	28942 2014	28940 1014	28940 2014	X-Large	11 1/4"	17" 3/4"

ToeOFF Item No. Left	ToeOFF Item No. Right	Size	Footplate Length	Height
28375 1010	28375 2010	X-Small	8 1/4"	14"
28375 1011	28375 2011	Small	9"	15"
28375 1012	28375 2012	Medium	9 5/8"	16"
28375 1013	28375 2013	Large	10 5/8"	17"
28375 1014	28375 2014	X-Large	11 1/4"	17"

ToeOFF 2.0 w/D-Ring Item No. Left	ToeOFF 2.0 w/D-Ring Item No. Right	ToeOFF 2.0 w/o D-Ring Item No. Left	ToeOFF 2.0 w/o D-Ring Item No. Right	Size	Footplate Length	Height
28922 1010	28922 2010	28920 1010	28920 2010	X-Small	8 1/4"	14"
28922 1011	28922 2011	28920 1011	28920 2011	Small	9"	15"
28922 1012	28922 2012	28920 1012	28920 2012	Medium	9 5/8"	16"
28922 1013	28922 2013	28920 1013	28920 2013	Large	10 5/8"	17"
28922 1014	28922 2014	28920 1014	28920 2014	X-Large	11 1/4"	17 3/4"

SIZE	SoftKIT™		ComfortKIT™	
	BlueROCKER ToeOFF	2.0	BlueROCKER ToeOFF	2.0
XS	28390 0010	28750 0010	28398 0010	28751 0010
SM	28390 0011	28750 0011	28398 0011	28751 0011
MED	28390 0012	28750 0012	28398 0012	28751 0012
LG	28390 0013	28750 0013	28398 0013	28751 0013
XL	28390 0013	28750 0014	28398 0013	28751 0014

COMBO®
a ToeOFF® Family product

allard USA
www.allardusa.com

ALLARD USA, INC.
300 Forge Way, Suite 3
Rockaway, NJ 07866-2056

info@allardusa.com
Toll Free 888-678-6548
Fax 800-289-0809

allard USA

COMBO® ... The Perfect Combination

World's Leading Carbon Composite AFO Technology
in a Carbon Graphite Hyperextension Knee Orthosis!

COMBO

- Anatomically Shaped Thigh Cuff
- Dual Axis Joints
- Popliteal Interface for Knee Extension Control
- Shapeable Stainless Steel Uprights
- Pre-contoured, yet Shapeable Tibia Connector



BlueROCKER® or ToeOFF®
The Original Dynamic Response Floor
Reaction Carbon Composite AFO

Custom Fabricate
a Super-Lightweight KAFO
in Your Own Facility!

www.allardusa.com



A1195M0813



FABRICATE A CUSTOM KAFO!

(Just 5 Components + BlueROCKER or ToeOFF)

TRACE

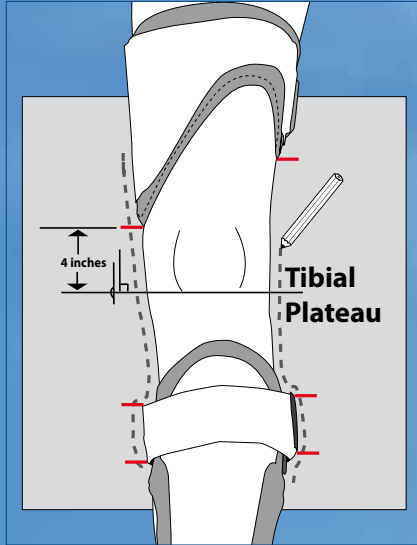

SHAPE

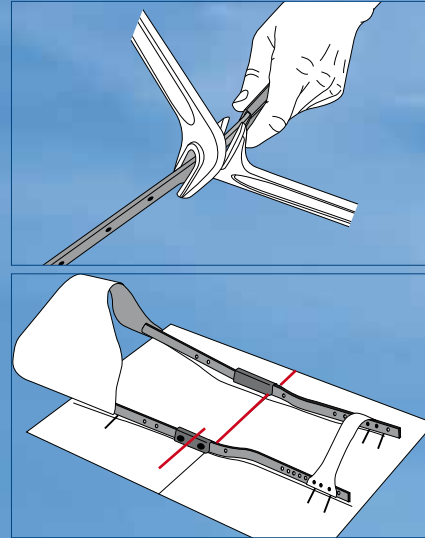

An Orthotist or Technician skilled in shaping metal KAFO uprights is required to fabricate the Perfect Combination.

FABRICATE

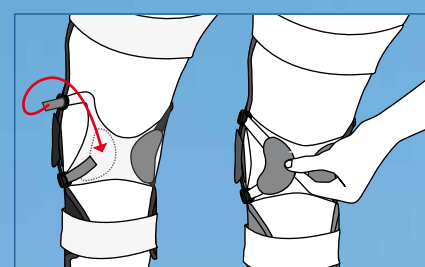
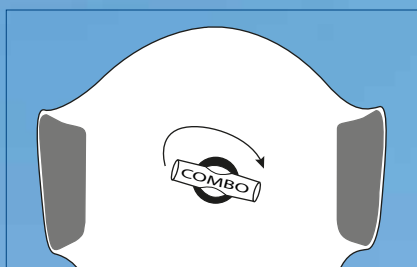
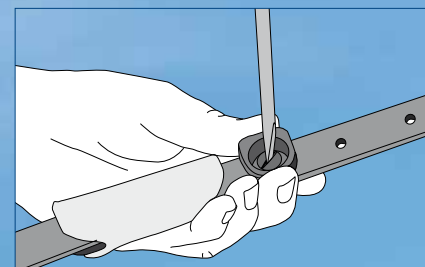
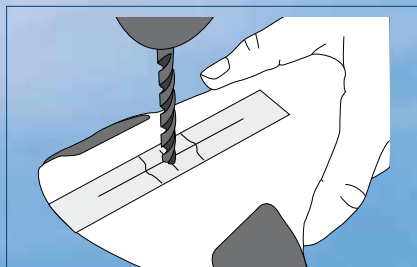
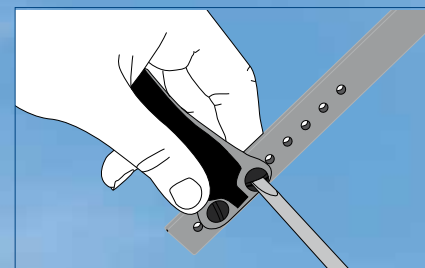
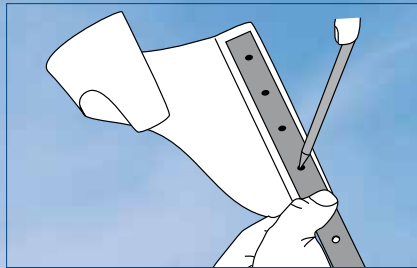

1 JOINTS WITH UPRIGHTS

Item No.	Size
28780 0000	One Size

2 TIBIA CONNECTOR

Generally, select the same size as the BlueROCKER or ToeOFF. However, the next smaller size will "snug" the wings of the BlueROCKER or ToeOFF closer to the leg for the extra small calf, and the next larger size may better accommodate a larger calf.

Item No.	Size
28784 0011	Small
28784 0012	Medium
28784 0013	Large/X-Large

3 KNEE CONTROL COMPONENT WITH POPLITEAL INTERFACE

Take a M-L (knee width) measurement.

Item No.	Size	Medial-Lateral
28782 0011	Small	2 3/4 - 4 1/4 in.
28782 0012	Medium	3 3/4 - 5 1/4 in.
28782 0013	Large	5 - 6 1/4 in.

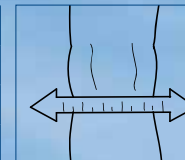

4 THIGH CUFF

Take a circumferential measurement at height where thigh cuff is to be located, however, make certain it is NOT LESS than 4" (10 cm) above the tibial plateau. Take a M-L measurement at same height.

Item No. Left	Item No. Right	Size	Circumference	M - L
28781 1011	28781 2011	Small	11 3/4 - 15 3/4 in.	4 1/4 - 6 in.
28781 1012	28781 2012	Medium	15 - 19 3/4 in.	5 1/4 - 6 in.
28781 1013	28781 2013	Large	19 - 23 3/4 in.	6 - 7 1/2 in.
28781 1014	28781 2014	X-Large	22 3/4 - 27 1/2 in.	6 3/4 - 8 1/4 in.

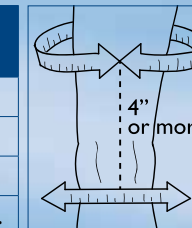

5 THIGH CUFF SOFTKIT

Same size as Thigh Cuff.

Item No.	Size
28783 0011	Small
28783 0012	Medium
28783 0013	Large
28783 0014	X-Large

*See back page for Replacement Components and BlueROCKER/ToeOFF ordering information

*BlueROCKER recommended for any patient who presents with > 15° of genu-recurvatum

*After fitting COMBO, it is not allowed to exceed 10° hyperextension inside the popliteal support.



- Uprights are easily attached to anatomically shaped thigh cuff that comfortably grasps the femur for stable fixation.
- Quick connect/release buckles easily attach the adjustable Knee Control Popliteal Interface.
- Tibia Connector is pre-contoured to fit the shape of the anterior plate of the BlueROCKER/ToeOFF, yet is shapeable to accommodate variance in calf circumference and still assure close fit to the anterior plate.

WARNING:

- Weight Limit: 330 pounds
- Height Limit: 6 1/2 feet (2m)
- Use of COMBO with any product other than BlueROCKER or ToeOFF is prohibited
- The COMBO KAFO requires a prescription and must be fit by or under the supervision of a Certified Orthotist.