

# Hand Therapy & Upper Extremity

## Soft Goods Product Directory







Hand & Wrist Orthoses



## Vission™ Universal Thumb Splint

Our Vission™ Universal Thumb Splint is patterned to fit the anatomy of either the right or left hand comfortably. The brace stabilizes the CMC and MP joints of the thumb to promote healing.

Proprietary memory foam laminate. Fabric integrated D-rings eliminate twisting. Easily shaped 1st MCP stay achieves desired positioning. Anatomically contoured fit for stabilization. Easy to locate contrasting color D-rings.

### Intended use:

Post-thumb fracture; Thumb intrinsic muscle injuries; Collateral ligament thumb injuries.

Item No.	Size	Measure
300990	Universal	One Size

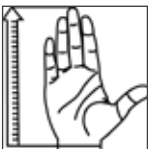
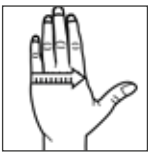

## S.O.T Thumb Orthosis

Soft yet compressing textile cover with no hard seams or edging. Molded and shaped palmar section with aluminum reinforcement to support the thumb in an optimal resting position.

S.O.T Thumb Orthosis is a completely new anatomically shaped orthosis for thumb and palm. The S.O.T Thumb Orthosis is designed to restrict movement in the CMC and MCP joints and to support the hand's arch. This is done by positioning the thumb's joints and muscles in a comfortable resting position. The S.O.T Thumb will help to avoid overstretched ligaments that can lead to joint subluxation.

The S.O.T Thumb orthosis has an adjustable aluminum core that can be easily formed to fit individual anatomy and can be adjusted as the contracture changes. To launder, simply place orthosis in a laundry bag, with cover attached, and machine wash at 104° F. This unique S.O.T Thumb Orthosis makes an excellent alternative to a custom-made thumb orthosis.

### Intended use:

Osteoarthritis, rheumatoid arthritis, adduction contracture of the thumb, overload injury of the CMC joint.

### Measurement:

MCP width / Length from wrist to end of finger.

Item No.	Product description	Side	Size	Width	Length
287201011	S.O.T Thumb Orthosis	Left	Small	≤ 3"	≤ 7.25"
287201012	S.O.T Thumb Orthosis	Left	Medium	≤ 3.25"	≤ 7.75"
287201013	S.O.T Thumb Orthosis	Left	Large	≤ 3.5"	≤ 8.25"
287202011	S.O.T Thumb Orthosis	Right	Small	≤ 3"	≤ 7.25"
287202012	S.O.T Thumb Orthosis	Right	Medium	≤ 3.25"	≤ 7.75"
287202013	S.O.T Thumb Orthosis	Right	Large	≤ 3.5"	≤ 8.25"

## SELECTION® Thumb Orthosis Rigid

Soft and elastic thumb orthosis with extra stability around the thumb structures. The design supports the muscles, keeping the thumb in neutral position and unloads CMC and MCP, but allows an active “pinch” grip. At rest the thumb is kept in neutral position without straining the muscles and tendons. Can be trimmed to the desired shape.

### Intended use:

Mild arthritis in the first CMC-joint. Protects the CMC-joint and the first MCP-joint. After trauma, in case of hyper mobile thumb and wrist, after arthroplasty surgery.

Item No. Left	Item No. Right	Colour	Size	Circumference Wrist
35202 1010	35202 2010	Black	X-Small	< 5"
35202 1011	35202 2011	Black	Small	5"-6"
35202 1012	35202 2012	Black	Medium	6"-6.75"
35202 1013	35202 2013	Black	Large	6.75"-8"
35202 1014	35202 2014	Black	X-Large	>8"



## VISSION™ Thumb Spica Laced

Our Vission™ Thumb Spica Laced provides a firm and comfortable support that is anatomically contoured to hold the wrist and thumb in a functional position to promote healing. Memory foam laminate for ultimate patient comfort. Anatomically contoured for superior fit. Malleable aluminum stays for customized fit. Quick lace system. Contoured, adjustable thumb-web strap. Integrated cotton knit panel for ease of application.

### Intended use:

Sprains and strains; Scaphoid injuries; Carpal Tunnel Syndrome; Gamekeeper's Thumb; DeQuervain's Syndrome.

### Measurement:

Wrist circumference.

Item No.	Product Description	Side	Size	Measure
300520L	Vission™ Thumb Spica Laced	Left	X-Small	5" - 5.75"
300530L	Vission™ Thumb Spica Laced	Left	Small	5.75" - 6.25"
300540L	Vission™ Thumb Spica Laced	Left	Medium	6.25" - 6.75"
300550L	Vission™ Thumb Spica Laced	Left	Large	6.75" - 7.75"
300560L	Vission™ Thumb Spica Laced	Left	X-Large	over 7.75"
300520R	Vission™ Thumb Spica Laced	Right	X-Small	5" - 5.75"
300530R	Vission™ Thumb Spica Laced	Right	Small	5.75" - 6.25"
300540R	Vission™ Thumb Spica Laced	Right	Medium	6.25" - 6.75"
300550R	Vission™ Thumb Spica Laced	Right	Large	6.75" - 7.75"
300560R	Vission™ Thumb Spica Laced	Right	X-Large	over 7.75"







## SELECTION® Fingerloop

A twin orthotic brace that efficiently holds 2 or more fingers together, with purpose to allow the stronger finger to support the weaker as support, protection or to increase ROM. Can also be used as a static progressive splint for increased ROM in DIP-joint. Made from 100% durable and quick drying nylon. Seamless material allows to be cut to individual shape. Either readymade straps or sheet which easily can be cut to individual straps in desired widths.

### Intended use:

Support for fingers after injury, surgery, stabile fractures, metacarpal fractures, chronic pain, sprains, contractures.

Item no.	Description	Size	Width	Length	Package
35219 0000	SELECTION® Fingerloop	One Size	2 cm	15.5 cm	5
35220 0000	SELECTION® Fingerloop Sheet	-	10 cm	15,5 cm	1



## SELECTION® open wrist children

A medium-stable wrist orthosis for children, with a removable shaped a luminum stay on the volar side. The unique feature of the orthosis with two thumb straps, one that attaches to the thumb and one that is attached to the back of the hand, gives better control of the abduction and adduction of the thumb.

SELECTION® Open Wrist for Children is intended to immobilize the CMC-joint and wrist to reduce pain, guide the wrist to a neutral position and when needed, support the wrist after trauma/surgery. The length of the orthosis is 16 cm on the volar side.

### Intended use

CP, Rheumatoid Arthritis, post trauma.



Item No. Left	Item No. Right	Colour	Size	Circumference Wrist	Palm measurement	Length Volar side
35306 1011	35306 2011	Black	Small	11,5 - 14 cm	7 - 8 cm	14,5 cm
35306 1012	35306 2012	Black	Medium	12 - 15,5 cm	8 - 9 cm	17 cm
35306 1013	35306 2013	Black	Large	14 - 16,5 cm	8 - 9 cm	17,5 cm

## SELECTION® Wrist Children

Medium stable wrist orthosis, especially developed for children. The orthosis has a removable aluminum stay on the volar side and two closing tabs attached to lacing for a simple one-step locking that also allows the width to be adjusted at wider forearm. Since the lacing comes from the ulnar side, there is reduced risk of thumb being positioned incorrectly. The thumb band is adjustable and the edges are soft. The color details are chosen to appeal to children. The length of the orthosis is 11 - 17.5 cm on the volar side.

### Intended use

Neurological disorders where wrist position needs mild correction or support. Inflammatory conditions. Rheumatic conditions.

Item No. Left	Item No. Right	Colour	Size	Circumference Wrist	Palm measurement	Length Volar side
35305 1009	35305 2009	Black	XX-Small	8,5 - 11 cm	5-6 cm	11 cm
35305 1010	35305 2010	Black	X-Small	10 - 12,5 cm	6-7 cm	13,5 cm
35305 1011	35305 2011	Black	Small	11,5 - 14 cm	7-8 cm	14,5 cm
35305 1012	35305 2012	Black	Medium	12 - 15,5 cm	8-9 cm	17 cm
35305 1013	35305 2013	Black	Large	14 - 16,5 cm	8-9 cm	17,5 cm





## VISSION™ Wrist Strapped 6"

Our Vission™ Wrist Strapped 6" provides firm and comfortable support. It is anatomically contoured to hold the wrist in a functional position to promote healing. Memory foam laminate for ultimate patient comfort. Anatomically contoured for superior fit. Malleable aluminum stays for customized fit. Easy to locate contrasting color D-rings. Contoured, adjustable thumb web strap. Integrated cotton knit panel for ease of application.

### Intended use:

Mild wrist sprains and strains; Tendonitis; Carpal Tunnel Syndrome; Overuse injuries; Tenosynovitis.

### Measurement:

Wrist circumference.

Item No.	Product Description	Side	Size	Measure
300120R	Vission™ Wrist Strapped 6"	Right	X-Small	5" - 5.75"
300130R	Vission™ Wrist Strapped 6"	Right	Small	5.75" - 6.25"
300140R	Vission™ Wrist Strapped 6"	Right	Medium	6.25" - 6.75"
300150R	Vission™ Wrist Strapped 6"	Right	Large	6.75" - 7.75"
300160R	Vission™ Wrist Strapped 6"	Right	X-Large	Over 7.75"
300120L	Vission™ Wrist Strapped 6"	Left	X-Small	5" - 5.75"
300130L	Vission™ Wrist Strapped 6"	Left	Small	5.75" - 6.25"
300140L	Vission™ Wrist Strapped 6"	Left	Medium	6.25" - 6.75"
300150L	Vission™ Wrist Strapped 6"	Left	Large	6.75" - 7.75"
300160L	Vission™ Wrist Strapped 6"	Left	X-Large	Over 7.75"



## VISSION™ Wrist Strapped 8"

Our Vission™ Wrist Strapped 8" provides firm and comfortable support. It is anatomically contoured to hold the wrist in a functional position to promote healing. Memory foam laminate for ultimate patient comfort. Anatomically contoured for superior fit. Malleable aluminum stays for customized fit. Easy to locate contrasting color D-rings. Contoured, adjustable thumb web strap. Integrated cotton knit panel for ease of application.

### Intended use:

Mild wrist sprains and strains; Tendonitis; Carpal Tunnel Syndrome; Overuse injuries; Tenosynovitis.

### Measurement:

Wrist circumference.

Item No.	Product Description	Side	Size	Measure
300020R	Vission™ Wrist Strapped 8"	Right	X-Small	5" - 5.75"
300030R	Vission™ Wrist Strapped 8"	Right	Small	5.75" - 6.25"
300040R	Vission™ Wrist Strapped 8"	Right	Medium	6.25" - 6.75"
300050R	Vission™ Wrist Strapped 8"	Right	Large	6.75" - 7.75"
300060R	Vission™ Wrist Strapped 8"	Right	X-Large	Over 7.75"
300020L	Vission™ Wrist Strapped 8"	Left	X-Small	5" - 5.75"
300030L	Vission™ Wrist Strapped 8"	Left	Small	5.75" - 6.25"
300040L	Vission™ Wrist Strapped 8"	Left	Medium	6.25" - 6.75"
300050L	Vission™ Wrist Strapped 8"	Left	Large	6.75" - 7.75"
300060L	Vission™ Wrist Strapped 8"	Left	X-Large	Over 7.75"





## VISSION™ Wrist Laced 6"

Our Vission™ Wrist Laced 6" provides firm comfortable support. It is anatomically contoured to hold the wrist in a functional position to promote healing. Memory foam laminate for ultimate patient comfort. Anatomically contoured for superior fit. Malleable aluminum stays for customized fit. Quick lace system. Contoured, adjustable thumb-web strap. Integrated cotton knit panel for ease of application.

### Intended use:

Mild wrist sprains and strains; Tendonitis; Carpal Tunnel Syndrome; Overuse injuries; Tenosynovitis.

### Measurement:

Wrist circumference.

Item No.	Product Description	Side	Size	Measure
300220R	Vission™ Wrist Laced 6"	Right	X-Small	5" - 5.75"
300230R	Vission™ Wrist Laced 6"	Right	Small	5.75" - 6.25"
300240R	Vission™ Wrist Laced 6"	Right	Medium	6.25" - 6.75"
300250R	Vission™ Wrist Laced 6"	Right	Large	6.75" - 7.75"
300260R	Vission™ Wrist Laced 6"	Right	X-Large	Over 7.75"
300220L	Vission™ Wrist Laced 6"	Left	X-Small	5" - 5.75"
300230L	Vission™ Wrist Laced 6"	Left	Small	5.75" - 6.25"
300240L	Vission™ Wrist Laced 6"	Left	Medium	6.25" - 6.75"
300250L	Vission™ Wrist Laced 6"	Left	Large	6.75" - 7.75"
300260L	Vission™ Wrist Laced 6"	Left	X-Large	Over 7.75"

## SELECTION® Wrist Soft

SELECTION®Soft is a medium-stable wrist orthosis that has the moulded CS-spoon on the volar side and a softer (1cm narrow) straight plastic stay on the dorsal side. Both stays are removable. The orthosis follows the hand's natural bend and less fabric around the thumb allows the thenar muscles to work freely. The two-piece closing system makes the orthosis easy to open and close with one hand and allows adjustment of the width to the forearm. Since the lacing comes from the ulnar side, the risk of misalignment of the thumb is reduced. Adjustable thumb grip. Due to the construction of the material it is possible to adjust the shape slightly by trimming with scissors. The length of the orthosis is 18 cm on the volar side.

### Intended use

Supports and relieves the wrist in cases such as rheumatic disorders and soft tissue injuries. Inflammation, overload or when degenerative changes are present.

Item No. Left Plastic Stay	Item No. Right Plastic Stay	Colour	Size	Circumference Wrist	Forearm measure*
35204 1010	35204 2010	Black	X-Small	< 11 cm	
35204 1011	35204 2011	Black	Small	11 - 14 cm	
35204 1115	35204 2115	Black	Small Plus	11 - 14 cm	18 - 21 cm
35204 1012	35204 2012	Black	Medium	14 - 17 cm	
35204 1125	35204 2125	Black	Medium Plus	14 - 17 cm	21 - 24 cm
35204 1013	35204 2013	Black	Large	17 - 20 cm	
35204 1135	35204 2135	Black	Large Plus	17 - 20 cm	24 - 27 cm
35204 1014	35204 2014	Black	X-Large	20 - 23 cm	
35204 1145	35204 2145	Black	X-Large Plus	20 - 23 cm	27 - 30 cm
35204 1015	35204 2015	Black	XX-Large	23 - 26 cm	
35204 1155	35204 2155	Black	XX-Large Plus	23 - 26 cm	30 - 33 cm





## SELECTION® Multiopen

SELECTION® Multiopen is a medium-stable wrist orthosis with dual locking function. It can be fully opened and then loosely closed with Velcro and tightened with lacing. The user can choose to open it completely each time the orthosis is donned or doffed, or use only the lacing function. The orthosis follows the hand's natural bend and less fabric around the thumb allows the thenar muscles to work freely. The two-piece drawstring in combination with the Velcro closure allows for the adjustment of the width for a wider forearm. As the lacing is on the ulnar side, the risk of misalignment of the thumb is reduced. There is also an adjustable thumb band on the volar side. Due to the construction of the material it is possible to slightly adjust the shape by trimming with scissors for optimal fit.

Made in the airy and comfortable SELECTION® material with all the functions that this offers. The orthosis is 22 cm long, 4 cm longer than a SELECTION® Soft 35204. It has a removable mouldable aluminium stay on the volar side.

### Intended use

Recovery after healed distal radius fracture, rheumatic disorders, soft tissue injuries or repetitive stress injuries. Inflammation, overload or when degenerative changes are present.

Item No. Left	Item No. Right	Colour	L/R	Size	Circumference Wrist
35209 1010	35209 2010	Black	L/R	X-Small	< 11cm
35209 1011	35209 2011	Black	L/R	Small	11 - 14 cm
35209 1012	35209 2012	Black	L/R	Medium	14 - 17 cm
35209 1013	35209 2013	Black	L/R	Large	17 - 20 cm
35209 1014	35209 2014	Black	L/R	X-Large	20 - 23 cm
35209 1015	35209 2015	Black	L/R	XX-Large	23 - 26 cm

## SELECTION® Radialis Thumb part

The SELECTION® range presents two new products, Radialis Finger and Radialis Thumb. These are sold as separate items to make it possible to combine them optimally. They are intended to be used when a Radialis Paresis is present (drop hand caused by damage to the radialis nerve) to assist functional gripping ability whilst the nerve recovers. These are intended to be combined with SELECTION® Wrist orthosis model numbers 35204, 35205 and 35209.

### Intended use

Radial nerve palsy.

Item No. Left	Item No. Right	Colour	Size	Length joint centre MCP1 - joint centre IP1
35216 1011	35216 2011	Black	Small	3 - 4 cm
35216 1013	35216 2013	Black	Large	5 - 6 cm

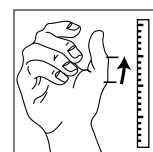

## SELECTION® Radialis Finger part

Radialis Finger Part comprises two sections that makes it easier to put on and adapt to the best fit. The Finger Part is attached to the soft plush material on the dorsal side of the orthosis. Simple to attach and comfortable to use. Can preferably be combined with Radialis Thumb Part.

### Intended use

Radial nerve palsy.

Item No. Left	Item No. Right	Colour	Size	Circumference MCP 2-5
35217 1011	35217 2011	Black	Small	17 - 20 cm
35217 1012	35217 2012	Black	Medium	20 - 23 cm
35217 1013	35217 2013	Black	Large	23 - 27 cm





## SELECTION® Wrist Orthosis Rigid

SELECTION® Rigid is a medium-stable wrist orthosis with a thumb section.

The brace has the moulded plastic CS-stay on the volar side and a softer (1cm narrow) straight plastic stay on the dorsal side. Both stays are removable. The thumb section gives support through its more rigid material. The orthosis follows the hand's natural bend. As the lacing comes from the ulnar side, risk of misalignment of the thumb is reduced. Due to the construction of the material it is possible to adjust the shape slightly by trimming with scissors, for optimal fit. The length of the orthosis is 18 cm on the volar side.

### Intended use

Supports and relieves the wrist and CMC-joint in cases such as rheumatic disorders and soft tissue injuries. Inflammation, overload or when degenerative changes are present.

Item No. Plastic Stay Left	Item No. Plastic Stay Right	Item No. Aluminum Stay Left	Item No. Aluminum stay Right	Colour	Size	Circumference Wrist
35206 1010	35206 2010	35192 1010	35192 2010	Black	X-Small	< 11 cm
35206 1011	35206 2011	35192 1011	35192 2011	Black	Small	11 - 14 cm
35206 1012	35206 2012	35192 1012	35192 2012	Black	Medium	14 - 17 cm
35206 1013	35206 2013	35192 1013	35192 2013	Black	Large	17 - 20 cm
35206 1014	35206 2014	35192 1014	35192 2014	Black	X-Large	20 - 23 cm
35206 1015	35206 2015	35190 1015	35192 2015	Black	XX-Large	23 - 26 cm



## SELECTION® Open wrist

SELECTION® Open wrist is a fully open model that is simple to don and doff. A small stop prevents the model to open completely. If needed the strap can easily be cut off. A medium-stable wrist orthosis that has the moulded plastic CS-stay on the volar side and a softer (1 cm narrow) straight plastic stay on the dorsal side. Both stays are removable. The orthosis follows the natural bend of the hand. Less fabric around the thumb allows the thenar muscles to work freely. The orthosis has an integrated wrap around strap and can easily be applied with one hand. The length of the orthosis is 18 cm on the volar side.

### Intended use

Supports and relieves the wrist in cases such as rheumatic disorders and soft tissue injuries. Inflammation, overload or when degenerative changes are present.

Item No.Left	Item No.Right	Colour	Size	Circumference Wrist
35207 1010	35207 2010	Black	X-Small	< 11 cm
35207 1011	35207 2011	Black	Small	11 - 14 cm
35207 1012	35207 2012	Black	Medium	14 - 17 cm
35207 1013	35207 2013	Black	Large	17 - 20 cm
35207 1014	35207 2014	Black	X-Large	20 - 23 cm





## SELECTION® Bromsa Wrist Orthosis

SELECTION® Bromsa Wrist Orthosis is designed to limit the stress on the tendons by providing a gentle dorsal extension “brake”, to remind and train the user to limit the extension of the wrist. Two stays are included to vary the degree of support. One stay gives mild stop, two stays gives a stronger stop. The SELECTION® lacing system gives a perfect fit and conforms around the wrist. The length of the orthosis is 15 cm on the volar side.

### Intended use

The product is intended to restrict movement in the wrist in order to off-load the hand extensors, support the wrist and reduce pain. Lateral Epicondylitis, hypermobility, rheumatic problems, unspecific pain.

Item No. Left	Item No. Right	Colour	Size	Circumference Wrist
35208 1010	35208 2010	Black	X-Small	<11 cm
35208 1011	35208 2011	Black	Small	11-14 cm
35208 1012	35208 2012	Black	Medium	14 - 17 cm
35208 1013	35208 2013	Black	Large	17 - 20 cm
35208 1014	35208 2014	Black	X-Large	20 - 23 cm



## SELECTION® Wrist Orthosis Short

Flexible, elastic wrist orthosis without stays, but with fabric reinforcement on the volar side. Low cut to follow the hand's natural bend. A locking system with lacing is easy to open and close with one hand. The closure on the ulnar side reduces the wrist of the thumb being positioned incorrectly. Adjustable thumb grip.

Due to the construction of the material it is possible to adjust the shape slightly by trimming with scissors. The length of the orthosis is 13 cm on the volar side.

### Intended use

Supports and relieves the wrist after injuries, surgery, hypermobility, chronic pain, arthritis, overloading. Can also be used as a preventative measure during heavy or repetitive movements.

Item No. Left	Item No. Right	Colour	Size	Circumference Wrist
35222 1010	35222 2010	Black	X-Small	< 11 cm
35222 1011	35222 2011	Black	Small	11 - 14 cm
35222 1012	35222 2012	Black	Medium	14 - 17 cm
35222 1013	35222 2013	Black	Large	17 - 20 cm
35222 1014	35222 2014	Black	X-Large	20 - 23 cm
35223 1010	35223 2010	Beige	X-Small	< 11 cm
35223 1011	35223 2011	Beige	Small	11 - 14 cm
35223 1012	35223 2012	Beige	Medium	14 - 17 cm
35223 1013	35223 2013	Beige	Large	17 - 20 cm
35223 1014	35223 2014	Beige	X-Large	20 - 23 cm



## SELECTION® Ulnar Deviation

Selection® Ulnar Deviation is intended for the management of Ulnar Deviation. Corrects alignment of joints of the fingers to improve extension, strength and function of the hand. Reduces pain and joint stiffness. Ulnar deviation is likely to be a characteristic for those with various forms of inflammatory disease, such as Rheumatoid Arthritis. This may also be used for realignment and stabilization in patients with joint laxity and muscle weakness.

### Intended use:

For patients with inflammatory and degenerative diseases, such as rheumatoid arthritis, that has resulted in ulnar deviation. Selection Ulnar Deviation can also be used for hyper-mobile joints and weak muscles to provide stability. Not intended for use with fixed contractures of the hand.



Item No. Left	Item No. Right	Colour	Size	Circumference MCP 2-5
35218 1010	35218 2010	Black	X-Small	5"-6 1/4"
35218 1011	35218 2011	Black	Small	6 1/4"-7 1/2"
35218 1012	35218 2012	Black	Medium	7 1/2"-8 3/4"
35218 1013	35218 2013	Black	Large	8 3/4"-9 3/4"



## S.O.T Resting Hand Orthosis

S.O.T (Smart Orthotic Treatment) is a resting orthosis for the spastic and paretic hand, when the goal is to maintain or increase the mobility of the hand. Now available in pediatric to adult sizes! The orthosis is smooth and lightweight. The S.O.T has an aluminum core which allows adjustment to the desired position. The aluminum core is embedded into polyethylene foam, which is covered with fabric. The brace is delivered in a resting position. A resting position can offer pain relief, relaxation to the hand and it also provides a good biomechanical position that may reduce the risk of flexor shortening of the wrist and fingers. The orthosis anatomic configuration supports the important thenar muscle, the CMC and MCP joint, which is particularly important for the intended patient groups, as the thumb tends to adduct at the CMC joint and hyperextend in the MCP joint. S.O.T Resting orthosis increases the conditions for an effective grip. Besides the extra wrist band, there are two other accessories: a finger divider and wedges in three different sizes.

### Intended use:

Stroke, Cerebral Palsy, Rheumatoid Arthritis, Radialis Paresis, Mucular Dystrophy, Edema, or Plexus Injury

### Measurement:

MCP width / Length from wrist to end of finger

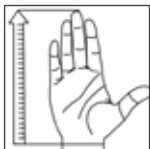
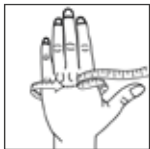

Item no.Left	Item no.Right	Description	Size	MCP Width	Wrist to finger top
28710 1008	28710 2008	S.O.T Resting splint	XXX-Small	5,5cm	≤ 12cm
28710 1009	28710 2009	S.O.T Resting splint	XX-Small	≤ 6,5cm	≤ 14cm
28710 1010	28710 2010	S.O.T Resting splint	X-Small	≤ 7,5cm	≤ 16cm
28710 1011	28710 2011	S.O.T Resting splint	Small	≤ 7,5cm	≤ 18.5cm
28710 1012	28710 2012	S.O.T Resting splint	Medium	≤ 8,5cm	≤ 20cm
28710 1013	28710 2013	S.O.T Resting splint	Large	≤ 9 cm	≤ 21cm
28711 0009		MCP wedge	XX-Small	Width 65mm	Height 10mm
28711 0011		MCP wedge	Small	Width 75mm	Height 15mm
28711 0013		MCP wedge	Large	Width 90mm	Height 20mm
28712 0003		Finger divider	Paediatric		
28712 0005		Finger divider	Medium		
28712 0007		Finger divider	Large		
28713 0009		Extra strap	XXXS-XS		
28713 0012		Extra strap	Small-Large		
28714 1008	28714 2008	Additional cover	XXX-Small		
28714 1009	28714 2009	Additional cover	XX-Small		
28714 1010	28714 2010	Additional cover	X-Small		
28714 1011	28714 2011	Additional cover	Small		
28714 1012	28714 2012	Additional cover	Medium		
28714 1013	28714 2013	Additional cover	Large		

## S.O.T Resting Hand Orthosis and Thumb Orthosis

To ensure proper fitting and use of accessories we have a guide that can be downloaded from the web site about Tips & Tricks for SOT Resting Hand Splint and also for the SOT Thumb Orthosis.

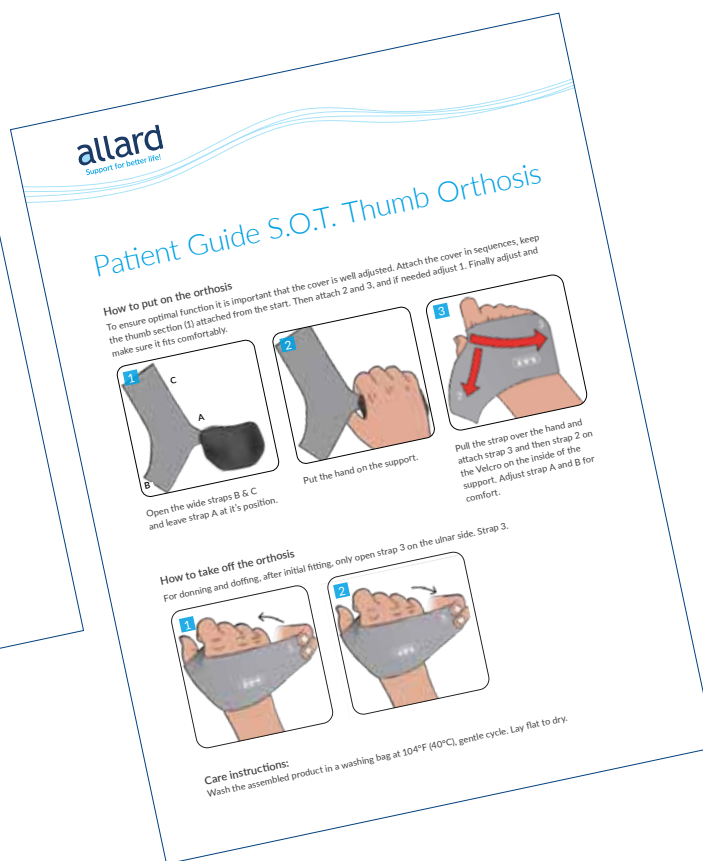
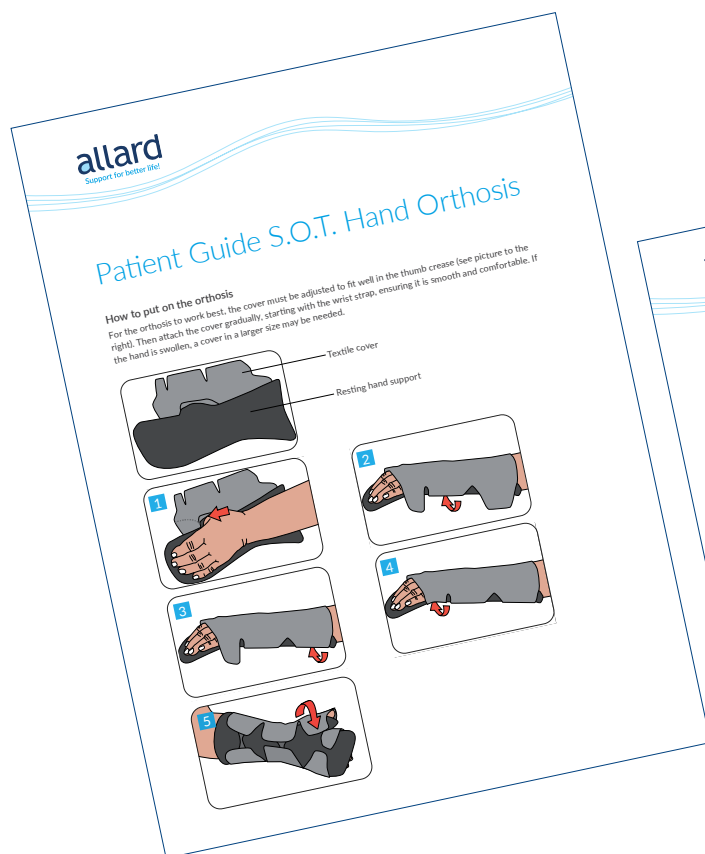

For both the Resting Hand Splint and the Thumb Orthosis fitting and adaptation videos can be found on the web site (under each of the products) and also on YouTube. For SOT Resting Hand Splint there are a variety of videos demonstrating the use of the Wedges, Finger Divider, Extra Wrist Strap and the best way to don and doff the product.







Arm & Shoulder Orthoses



## VISSION EPI

The Vission EPI offers adjustable pressure over the flexor and extensor muscles to help relieve pain/discomfort associated with Epicondylitis. Includes two repositionable foam pads.

### Intended use:

Mild and temporary medial and lateral epicondylitis (tennis / golf elbow).

### Measurement:

Circumference at 2" below elbow.

Item No.	Size	Arm circumference
315130	S/M	8"-11"
315140	L/XL	12+"

## VISSION™ Clavicle Splint

Our Vission™ Clavicle Splint offers comfortable support to the injured or post-operative clavicle. The splint can also be used to improve posture. Extra padding where straps join at center back. Fabric integrated D-rings eliminate strap twisting. Figure 8 design. Step down a size to limit patient adjustment. Soft foam laminated material.



### Intended use:

Clavicle fractures, grade II & III acromioclavicular separations, osteolysis of the clavicle, AC degenerative joint pain, mechanical cervical disease, postural dysfunction, sternoclavicular dislocations.

Item No.	Product Description	Size	Size
202130	Vission™ Clavicle Splint	Children	Small
202140	Vission™ Clavicle Splint	Youth/Small Adults	Medium
202150	Vission™ Clavicle Splint	Adults	Large
202160	Vission™ Clavicle Splint	Large Adults	X-Large

## VISSION™ Mesh Contoured Sling

Our Vission™ Mesh Contoured Sling provides comfortable support to the affected arm/shoulder to promote healing. The contoured seams of the open mesh provide superior anatomical fit. Optimum breathability. Unique anatomical contour prevents the arm from sliding in the sling. Soft plush thumb loop. Mesh fabric adds a flair of fashion.

### Intended use:

Cast support; Injuries to the arm, wrist or hand; Acromioclavicular sprains; Anterior glenohumeral dislocations.

### Measurement:

Length from elbow to wrist.

Item No.	Product Description	Side	Measure
310130	Vission™ Mesh Contoured Arm Sling	Small	7" - 9"
310140	Vission™ Mesh Contoured Arm Sling	Medium	9" - 11"
310150	Vission™ Mesh Contoured Arm Sling	Large	11" - 13"
310160	Vission™ Mesh Contoured Arm Sling	X-Large	13" - 15"

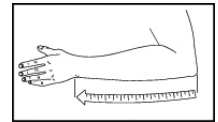



### **Support for Better Life**

Everyone should be able to live their life to the fullest, regardless of their mobility challenges. With innovative solutions developed in close collaboration with healthcare professionals and patients, we strive to provide Support for Better Life.

# allard

Allard USA Inc.

300 Forge Way, Suite 3, Rockaway NJ 07866-2056, USA | 888-678-6548 | [info@allardusa.com](mailto:info@allardusa.com) | [allardusa.com](http://allardusa.com)