

CSUS

by Allard USA

C|s

EPI STRAP
Rx Only — Single Patient Use Only

C|s

Instructions for Use

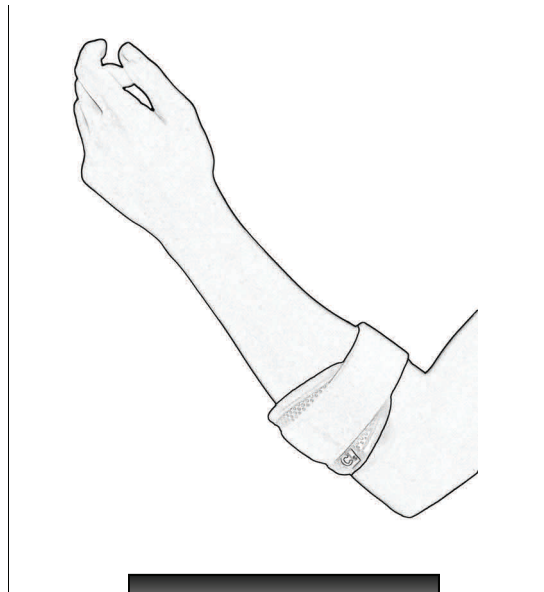

FEEL THE FUNCTION

The intended function of this brace is to help relieve pain due to mild to moderate Tennis or Golfer's Elbow. Review instructions on back page carefully before application.

For questions, please contact your physician, the professional who fit this device or Allard USA Customer Service:

CALL: 888-678-6548 FAX: 800-289-0809
info@allardusa.com

Allard USA, Inc. 300 Forge Way, Suite 3 Rockaway, NJ 07866-2056
www.allardusa.com

CSUS

by Allard USA

C|s

EPI STRAP
Rx Only — Single Patient Use Only

C|s

Instructions for Use



FEEL THE FUNCTION

The intended function of this brace is to help relieve pain due to mild to moderate Tennis or Golfer's Elbow. Review instructions on back page carefully before application.

For questions, please contact your physician, the professional who fit this device or Allard USA Customer Service:

CALL: 888-678-6548 FAX: 800-289-0809
info@allardusa.com

Allard USA, Inc. 300 Forge Way, Suite 3 Rockaway, NJ 07866-2056
www.allardusa.com

EPI

1. Open support and place on flat surface with logo tag face down.

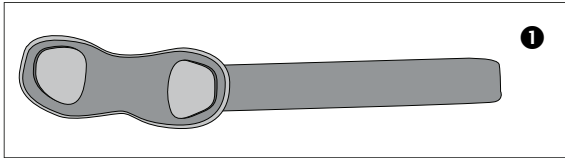

2. With palm of hand facing up, place affected arm onto support as shown. Support should be positioned just below elbow.

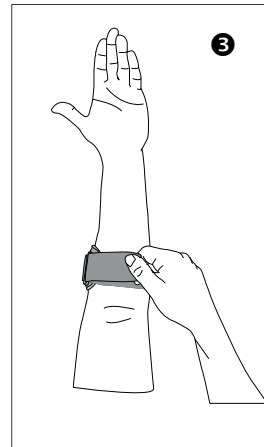
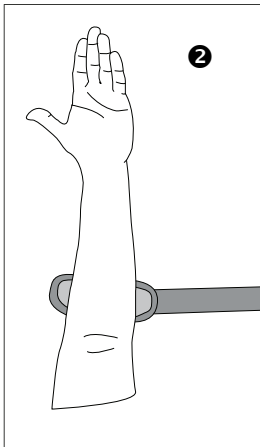

3. Wrap main strap around arm and pull back through D-ring. Secure for a snug, comfortable fit.

4. For less pressure, remove the pads. For increased pressure, both pads can be used on the same side.

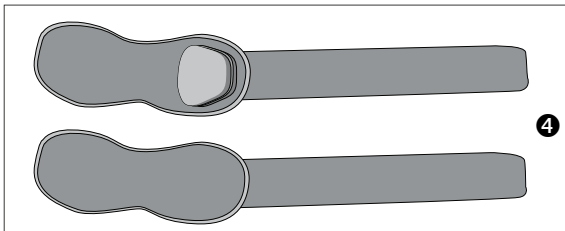

Indications / Intended Use

Treatment of mild and temporary conditions of tennis or golfer's elbow.

Contraindications

Severe edema; Severe swelling.

Wash instruction

Hand wash in cold water using mild detergent.

Air dry.

Adjustment

This brace should only be fitted by a licensed medical professional.

Warning

If wearing the brace causes any unusual reactions, swelling or prolonged pain, remove and consult your medical professional. Check skin on a daily basis.

EPI

1. Open support and place on flat surface with logo tag face down.

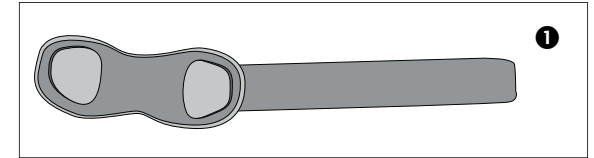

2. With palm of hand facing up, place affected arm onto support as shown. Support should be positioned just below elbow.

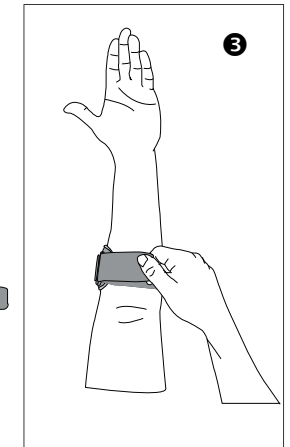
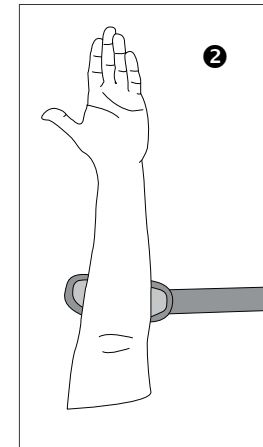

3. Wrap main strap around arm and pull back through D-ring. Secure for a snug, comfortable fit.

4. For less pressure, remove the pads. For increased pressure, both pads can be used on the same side.

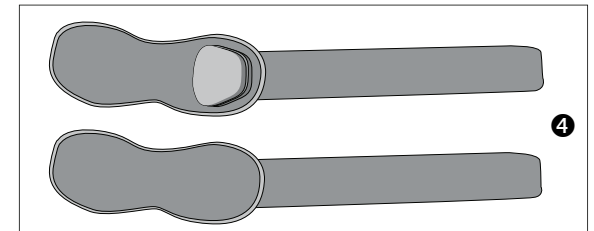

Indications / Intended Use

Treatment of mild and temporary conditions of tennis or golfer's elbow.

Contraindications

Severe edema; Severe swelling.

Wash instruction

Hand wash in cold water using mild detergent.

Air dry.

Adjustment

This brace should only be fitted by a licensed medical professional.

Warning

If wearing the brace causes any unusual reactions, swelling or prolonged pain, remove and consult your medical professional. Check skin on a daily basis.